

CRUSE & ASSOCIATES

PROFESSIONAL LAND SURVEYORS

MT. SPRING EST./ERDMAN BLA DESCRIPTIONS

9/17/14

Revised Parcel 20 (20.00 ac.)

Parcel 20 of that certain survey as recorded April 18, 2007 in Book 34 of Surveys at pages 13-16, under Auditor's File No. 200704180012, records of Kittitas County, Washington; being a portion of the Southeast Quarter of Section 31, and a portion of the Southwest Quarter of Section 32, all in Township 18 North, Range 18 East, W.M., in the County of Kittitas, State of Washington;

EXCEPT that portion thereof lying southeasterly of a line described as follows:

Beginning at the northwest corner of Lot 22B, of the DYK/ERDMAN SHORT PLAT (Kittitas County Short Plat No. SP-12-00001), recorded in Book K of Short Plats, pages 249-251, under Auditor's File No. 201207180001, records of Kittitas County, Washington, said corner being the true point of beginning for said described line; thence N 30°17'16" E, 124.15 feet; thence N 56°34'10" E, 136.96 feet; thence N 62°27'43" E, 193.78 feet; thence N 66°43'34" E, 84.11 feet; thence S 66°28'07" E, 76.82 feet to a point on the easterly boundary of said Parcel 20 and the end of said described line.

Revised Lot 22B (8.37 ac.)

Lot 22B, of the DYK/ERDMAN SHORT PLAT (Kittitas County Short Plat No. SP-12-00001), recorded in Book K of Short Plats, pages 249-251, under Auditor's File No. 201207180001, records of Kittitas County, Washington; being a portion of the Southeast Quarter of Section 31, Township 18 North, Range 18 East, W.M., in the County of Kittitas, State of Washington.

AND

That portion of Parcel 20 of that certain survey as recorded April 18, 2007 in Book 34 of Surveys at pages 13-16, under Auditor's File No. 200704180012, records of Kittitas County, Washington; being a portion of the Southeast Quarter of Section 31, and a portion of the Southwest Quarter of Section 32, all in Township 18 North, Range 18 East, W.M., in the County of Kittitas, State of Washington, lying southeasterly of a line described as follows:

Beginning at the northwest corner of above said Lot 22B, said corner being the true point of beginning for said described line; thence N 30°17'16" E, 124.15 feet; thence N 56°34'10" E, 136.96 feet; thence N 62°27'43" E, 193.78 feet; thence N 66°43'34" E, 84.11 feet; thence S 66°28'07" E, 76.82 feet to a point on the easterly boundary of said Parcel 20 and the end of said described line.

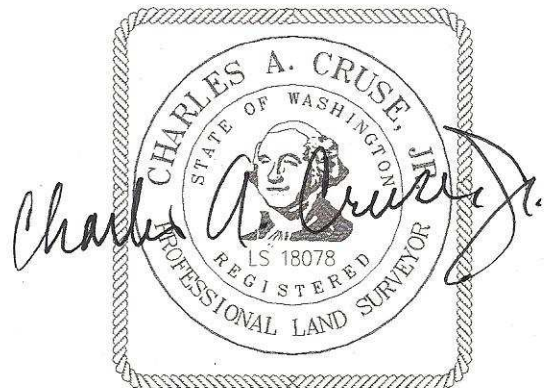

9-17-14

